

| POS. | NUMBER | PCS | NAME |
|------|-------------------|-----|-----------------------|
| 1 | 20-06758 | 6 | Pillar + Support 2.8m |
| 2 | 20-06760 | 6 | Pillar 1200 mm |
| 3 | 20-06762 | 6 | Pillar 1700 mm |
| 4 | M10_20(ISO 7380) | 62 | Bolt (ISO 7380) |
| 5 | M10_d10.5 | 62 | Flat washer D=10,5 |

| | | | |
|-------------------------------|------|------------------------|-------------------|
| Surface coating | | Total NDFI 100mkm | |
| Painting | | ZN(R) primer - 50 mkmm | Topcoat - 50 mkmm |
| Hot dip galvanizing | | HDG acc. ISO 1461 | |
| Other | | | |
| Revision | Date | | |
| No | | | |
| A06 | | | |
| A05 | | | |
| A04 | | | |
| A03 | | | |
| A02 | | | |
| A01 | | | |
| | | DIN / ISO | Class |
| Welded parts tolerances | | ISO 13920 | B F |
| Welding joint quality level | | ISO5817 | C |
| Stamped steel parts | | DIN 6930 | g |
| Linear and angular dimensions | | ISO 2768 | c L |
| | | Material: | |
| | | Surf.Area 24.70 | |
| | | Mass 331.23 | |
| | | Name: Over Under | |
| | | Drawing No: 20-06759 | |
| | | A3 | |
| | | AE | |
| | | SCALE:1:40 | |
| | | Sheet 1 of 3 | |



Table 4 — Examples of commonly used impact attenuating materials, depths and corresponding maximum free heights of fall

| Material ^a | Description | Minimum depth ^b | Maximum free heights of fall |
|-------------------------------------------------------------------------------------------------------------------------------------------------------------------------------------|--------------------------------|--------------------------------|------------------------------|
| | mm | mm | mm |
| Where the installed surfacing is verified (e.g. sieve test) as being in accordance with this table or carries a test report according to EN 1177, no additional testing is required | | | |
| Turf/topsoil | — | — | ≤ 1 000 ^d |
| Bark | 20 to 80 particle size | 200 | ≤ 2 000 |
| | | 300 | ≤ 3 000 |
| Woodchip | 5 to 30 particle size | 200 | ≤ 2 000 |
| | | 300 | ≤ 3 000 |
| Sand or gravel ^c | 0.25 to 8 grain size | 200 | ≤ 2 000 |
| | | 300 | ≤ 3 000 |
| Other materials and other depths | As tested according to EN 1177 | Critical fall height as tested | |

^a For further information on specific material properly prepared for use in children's playgrounds see CEN/TR 16598 (Collection of Rationales for EN 1176-1 requirements).

^b For loose particulate material, add 100 mm to the minimum depth to compensate for displacement (see 4.2.8.5.1).

^c Sand and gravel shall be well rounded and washed to eliminate most of the silt or clay particles. Washed sand or gravel is considered to be from alluvial (naturally eroded) deposits and free from most silt or clay particles. For gravel this may commonly be described as 'pea shingle'. Uniformity coefficient D60/D10 < 3,0. Grain size can be identified by use of a sieve test, as in EN 933-1 (see Annex G).

^d See NOTE 2 in 4.2.8.5.2.

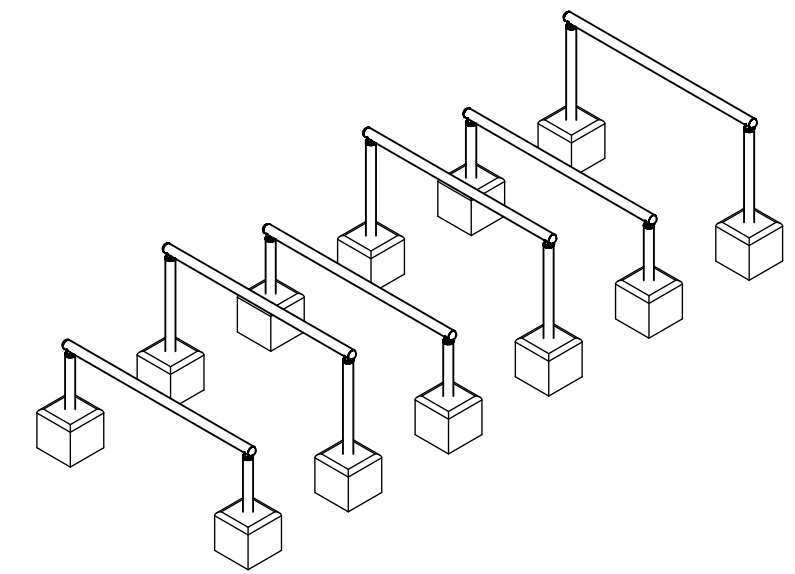
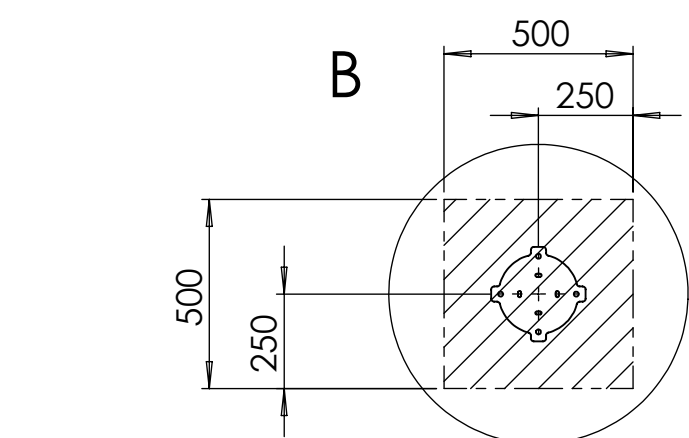
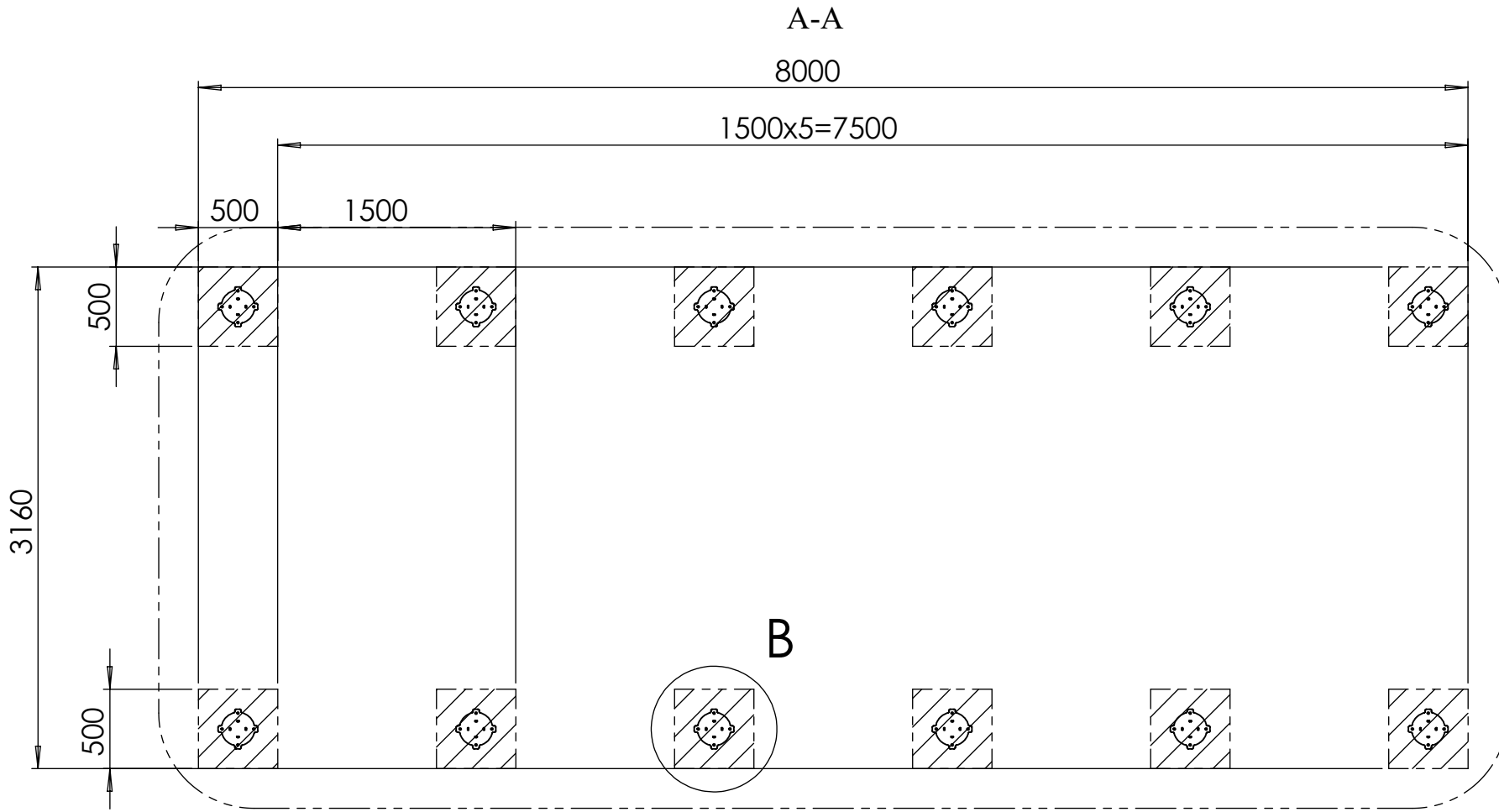
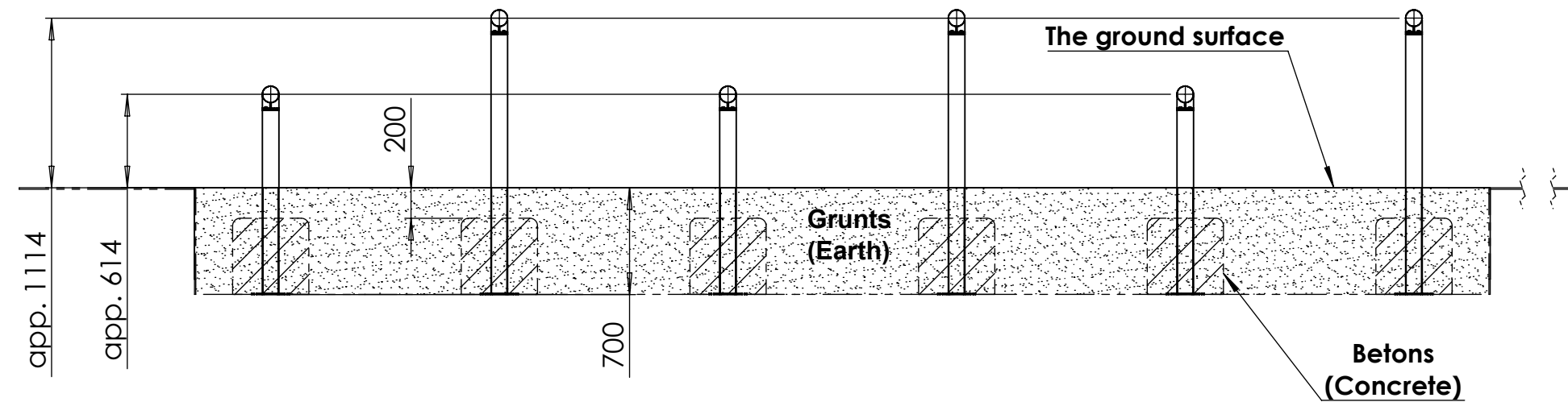

| | | | | | |
|-------------------------------|--|------------------------------------------|-------|--------------|--|
| Surface coating | | Total NDFY 100mkm | | | |
| Painting | | Zn(R) primer - 50 mkm Topcoat - 50 mkm | | | |
| Hot dip galvanizing | | HDG acc. ISO 1461 | | | |
| Other | | | | | |
| Revision | | Date | | | |
| No | | | | | |
| A06 | | | | | |
| A05 | | | | | |
| A04 | | | | | |
| A03 | | | | | |
| A02 | | | | | |
| A01 | | | | | |
| | | DIN / ISO | Class | | |
| Welded parts tolerances | | ISO 13920 | B F | | |
| Welding joint quality level | | ISO 5817 | C | | |
| Stamped steel parts | | DIN 6930 | g | | |
| Linear and angular dimensions | | ISO 2768 | c L | | |
| | | Material: | | | |
| | | Surf. Area | | 24.70 | |
| | | Mass | | 331.23 | |
| | | Name: | | Over Under | |
| | | Drawing No: | | 20-06759 | |
| | | SCALE:1:40 | | Sheet 2 of 3 | |
| | | | | A3 | |
| | | | | AE | |

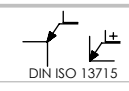
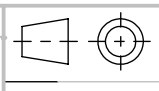

Surf. Area 24.70
Mass 331.23

Over Under

20-06759

A3

AE

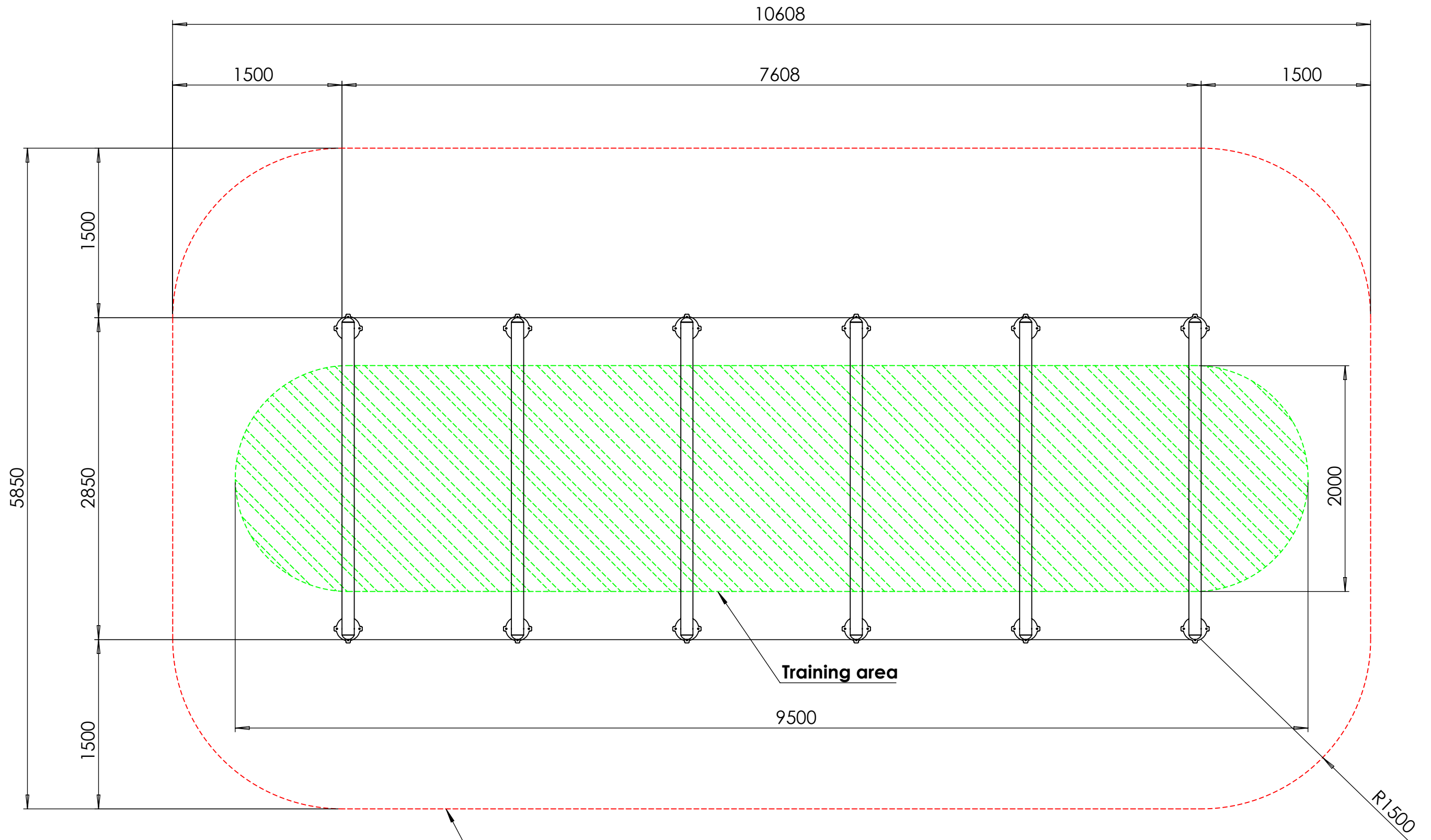

| | | | | | |
|-------------------------------|----------|-----------------------|----------------------|------------------|--------------------------------|
| Surface coating | | Total NDFI 100mkm | | | |
| Painting | | ZN(R) primer - 50 mkm | | Topcoat - 50 mkm | |
| Hot dip galvanizing | | HDG acc. ISO 1461 | | | |
| Other | | | | | |
| No | Revision | Date | | | |
| A06 | | | | | |
| A05 | | | | | |
| A04 | | | | | |
| A03 | | | | | |
| A02 | | | | | |
| A01 | | | | | |
| | | DIN / ISO | Class | | |
| Welded parts tolerances | | ISO 13920 | B F | | |
| Welding joint quality level | | ISO5817 | C | | |
| Stamped steel parts | | DIN 6930 | g | | |
| Linear and angular dimensions | | ISO 2768 | c.L | Material: | |
| | | | | | |
| | | | Name: Over Under | | Surf.Area 24.70 Mass 331.23 |
| | | | Drawing No: 20-06759 | | A3 |
| | | | SCALE:1:35 | | AE |
| | | | Sheet 3 of 3 | | |